

Compressor

Replacement

1. Run the engine at idle speed and turn on the air conditioner for a few minutes.
2. Disconnect the battery negative terminal.
3. Disconnect the compressor clutch lead.
4. Remove the left front under cover and the engine lower grille cowl.
5. Discharge the refrigerant very slowly from the system. (page 24-27).
6. Remove the receiver by disconnecting pipes.

CAUTION: Cap the open fittings immediately to keep moisture and dirt out of the system.

7. Disconnect the discharge hose and suction hose from compressor.

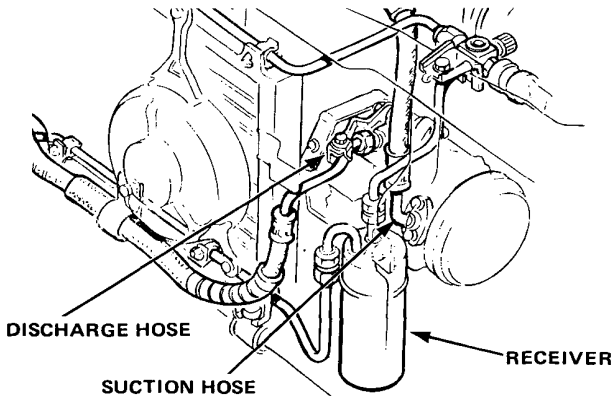

8. Loosen the belt adjusting bolt and pulley nut then lift the belt off the pulley.
9. Remove the nut and compressor mounting bolts.

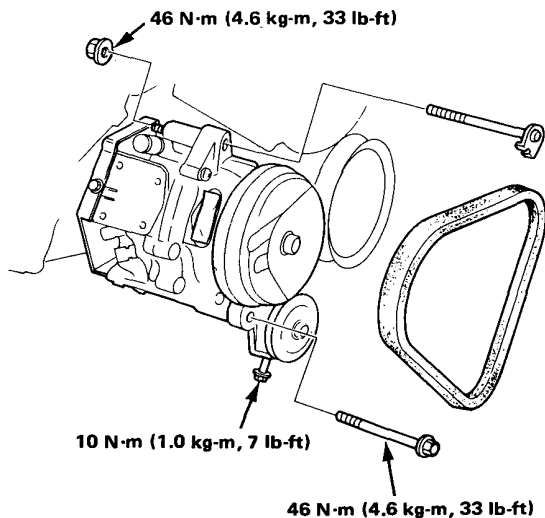

10. Remove the pulley bracket and remove the compressor from between the radiator and engine.

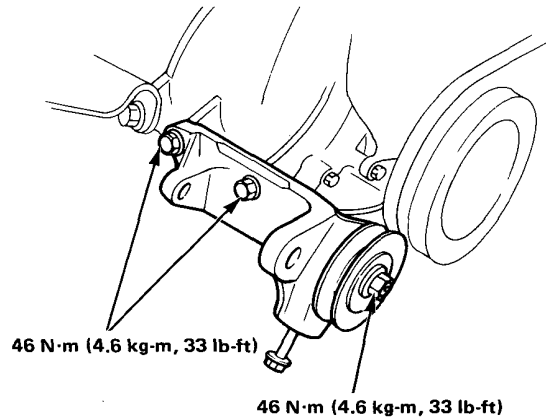

Install the compressor in the reverse order of removal, and:

- If a new compressor is installed, drain 30 cm³ (cc) (1 fl oz.) of refrigerant oil through the suction fitting on the compressor.
- Adjust the belt
Belt tension: 7–9 mm (9/32–11/32 in.) deflection when 98N (10 kg, 22 lbs) force is applied between pulleys.
- Charge the system (page 24-29).
- Test the performance (page 24-15)

CAUTION: Do not loosen the cylinder cover bolts on the compressor.